

| | |
|--|---|
| | 230 Vac |
| | 5(2) A max : Q1,Q2,Q3-N 5(2) A max : Y11-N / Y21-N 6 A max : Qx + Yxx |
| | 50/60 Hz |
| | 1 x 1,5 mm ² |
| | 0 45 °C |

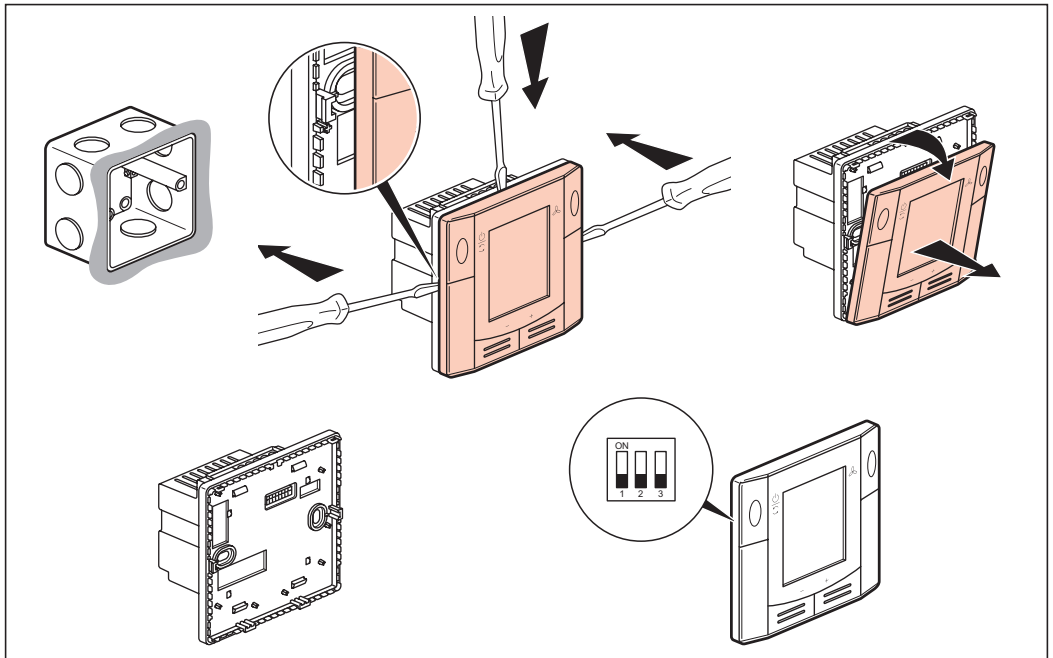

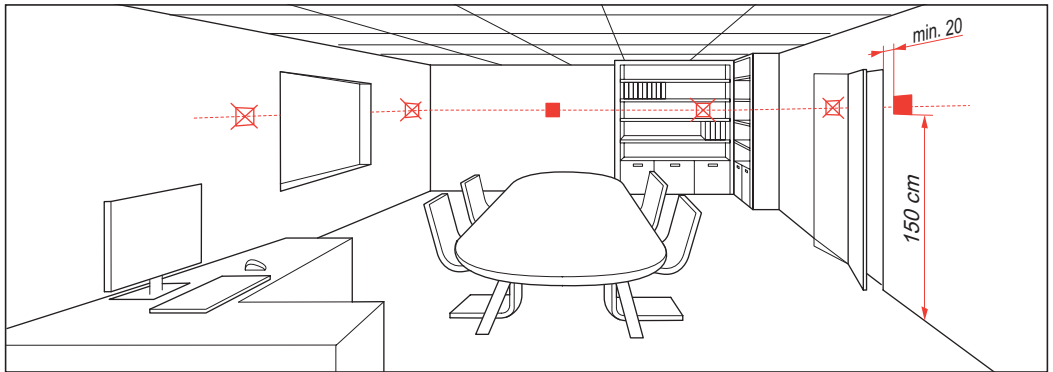

- Application
- Anwendung
- Applicazione
- 应用

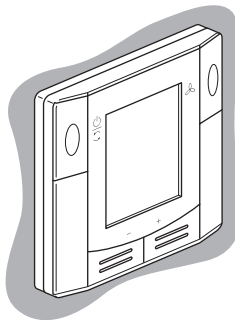
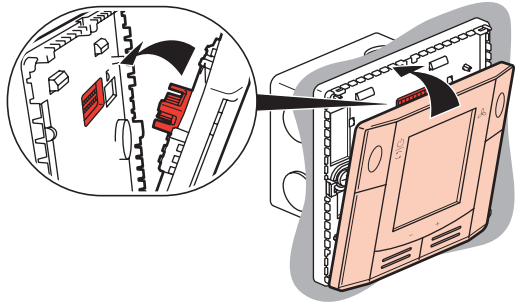
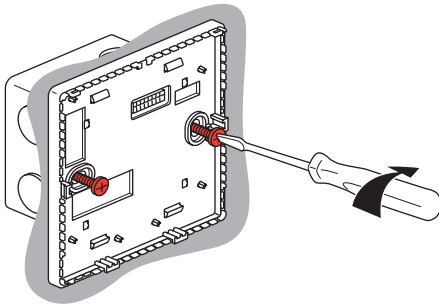
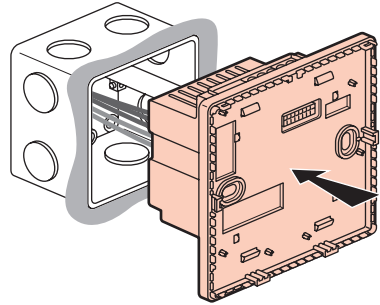
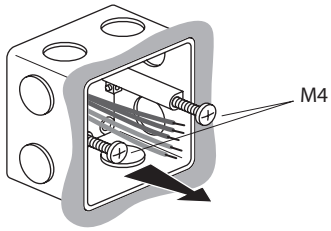

- 2 tubes
- 2-pipe
- 2-Rohr
- 2 tubi
- 两管制

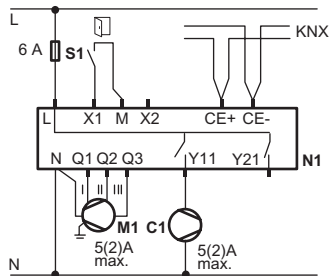
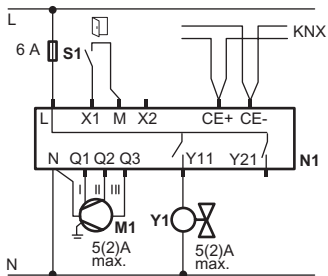

- 2 tubes & chauffage électrique
- 2-pipe & electric heater
- 2-Rohr & elektrische Heizung
- 2 tubi e riscaldamento elettrico
- 两管制, 带电加热

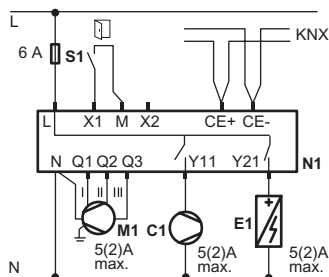
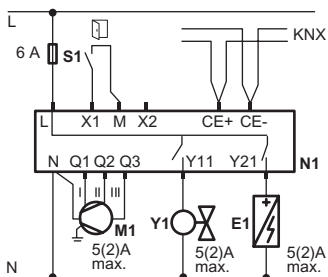
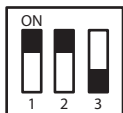

- 4 tubes
- 4-pipe
- 4-Rohr
- 4 tubi
- 四管制

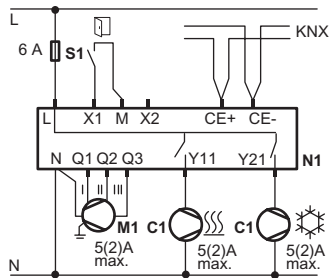
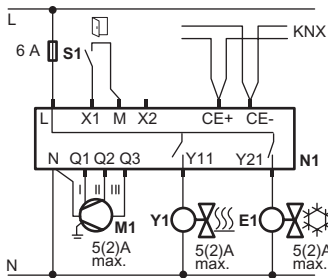

- 2 tubes, contrôle 3 positions
- 2-pipe, 3-position output
- 2-Rohr, 3-Punkt-Ausgang
- 2 tubi, uscita a 3 punti
- 两管制, 三位控制输出

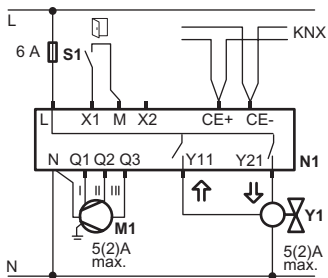
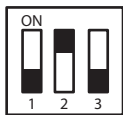



PROG
KNX

6 s

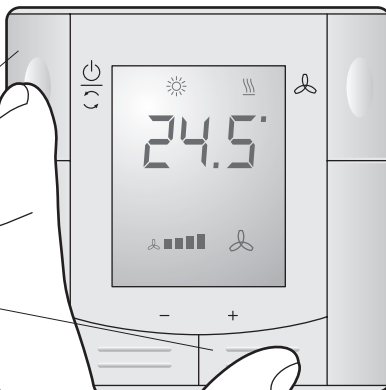

| | • Légende | • Legend | • Legende | • Legenda | • 图例 |
|--------|------------------------|--|--|--|------------------|
| N1 | 0 490 31 | 0 490 31 | 0 490 31 | 0 490 31 | 0 490 31 |
| M1 | Ventilateur 3 vitesses | 3-speed fan | 3-stufiger Ventilator | Ventilatore a tre velocità | 三速风机 |
| Y1, Y2 | Vanne | Valve | Ventil | Valvola | 阀门 |
| C1, C2 | Compresseur | Compressor | Kompressor | Compressore | 压缩机 |
| E1 | Chauffage électrique | Electric heater | El. Heizung | Riscaldamento elettrico | 电加热 |
| S1 | Mode de fonctionnement | Operating mode switch-over contact (e.g. key card) | Betriebsart-Umschalter (z.B. Zugangskarte) | commutatore modalità di funzionamento (per es. carta di accesso) | 工作模式转换开关 (例如：门卡) |