

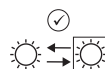

CE

IP55

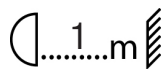

$t_{\min} -25^{\circ}\text{C}$

$t_a +25^{\circ}\text{C}$

1

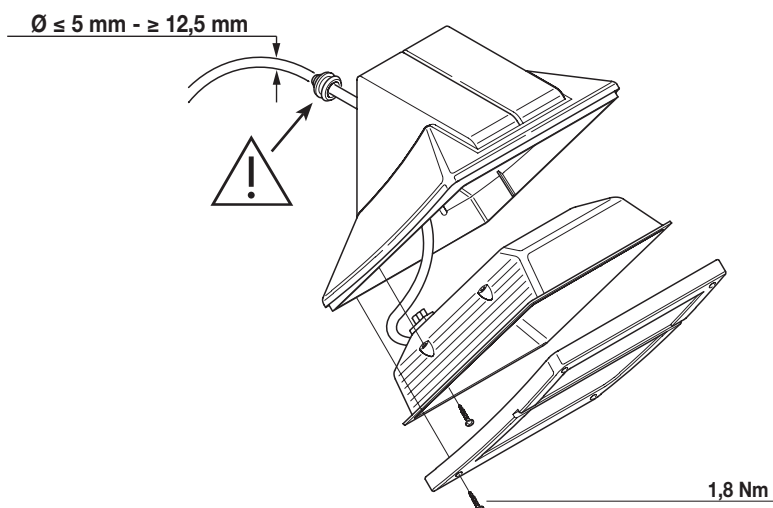

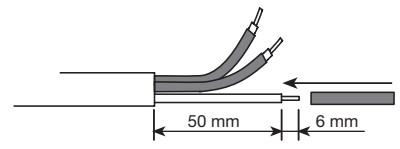
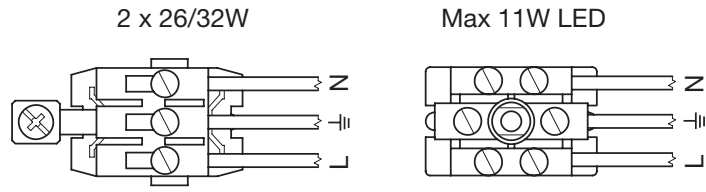

3

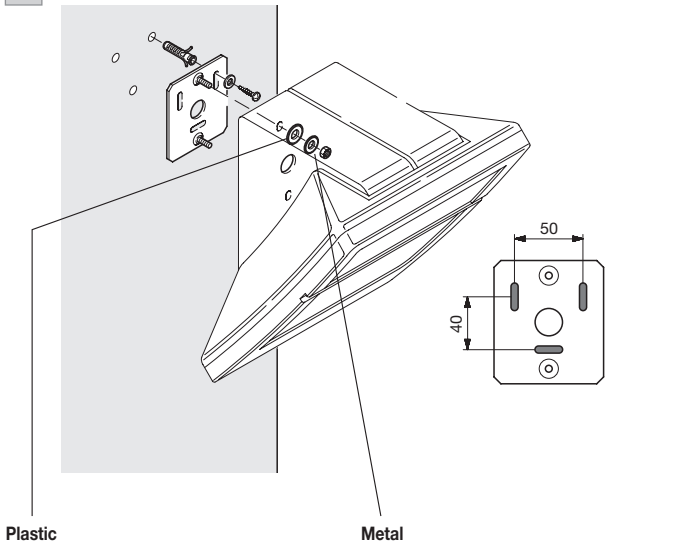

4

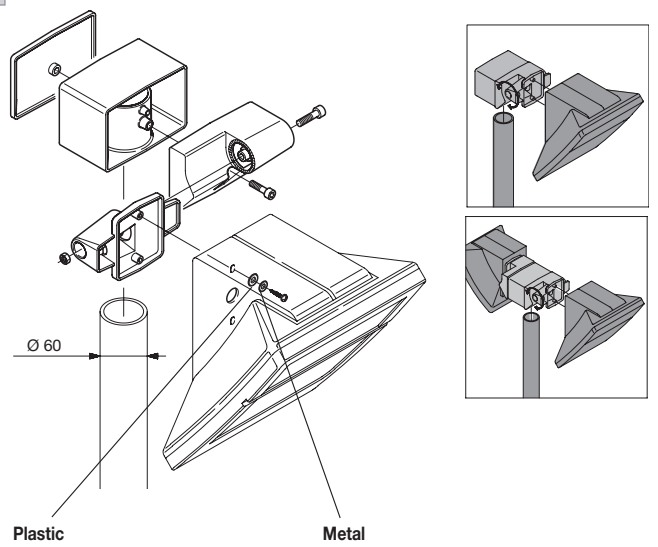

5

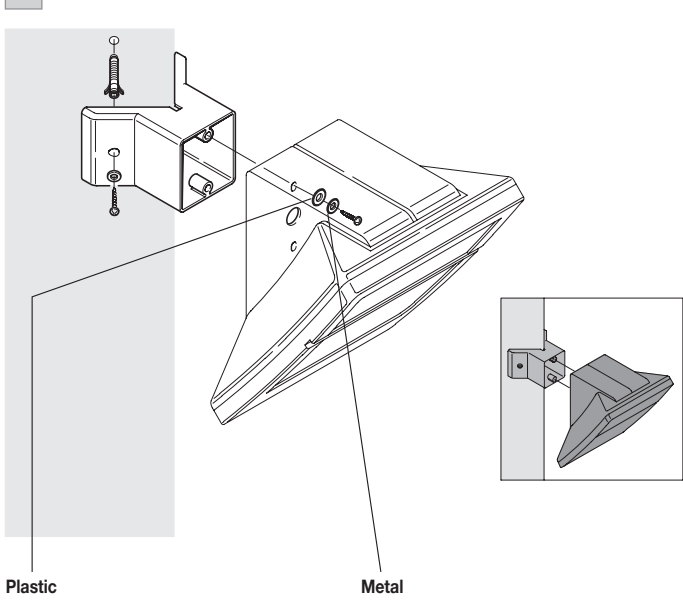

6

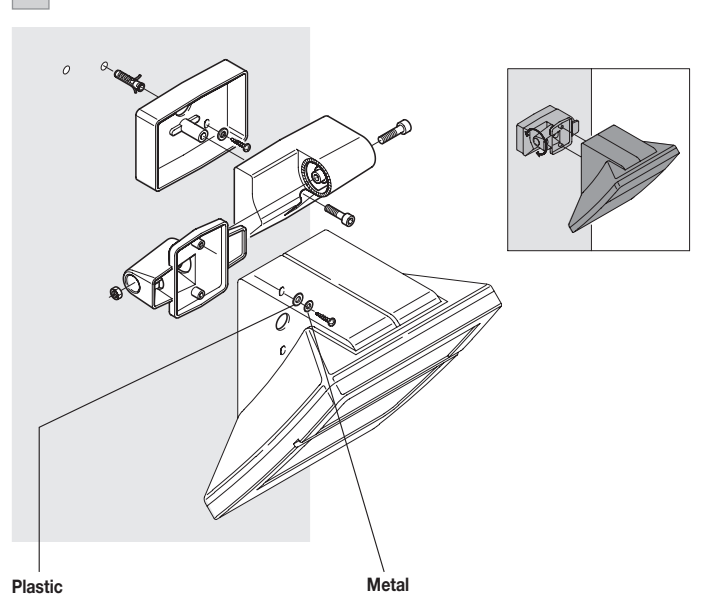

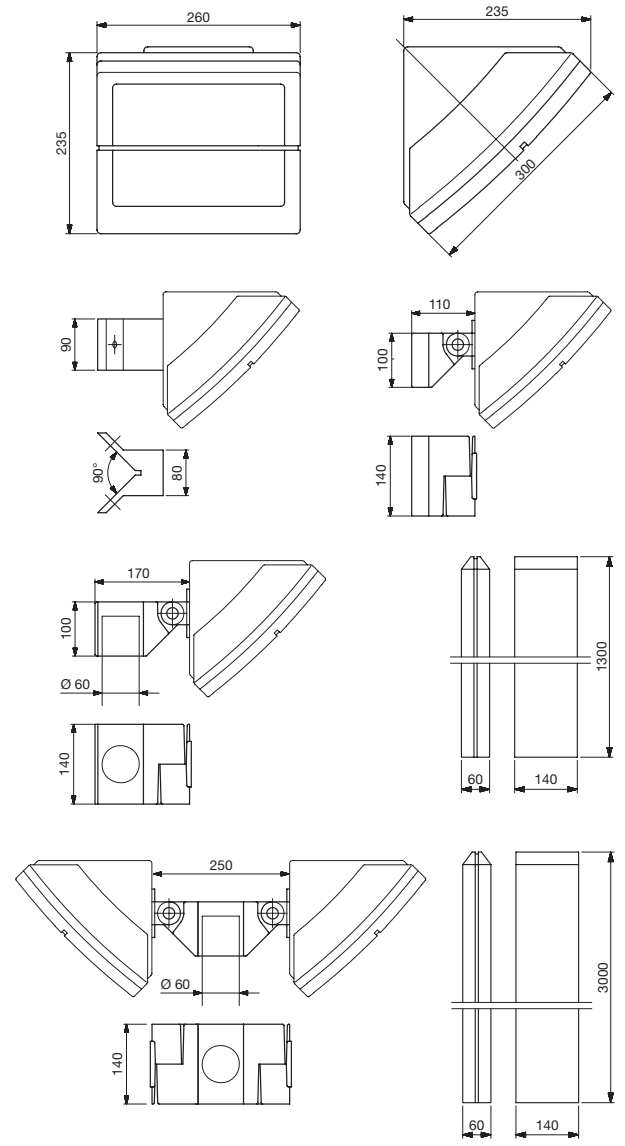
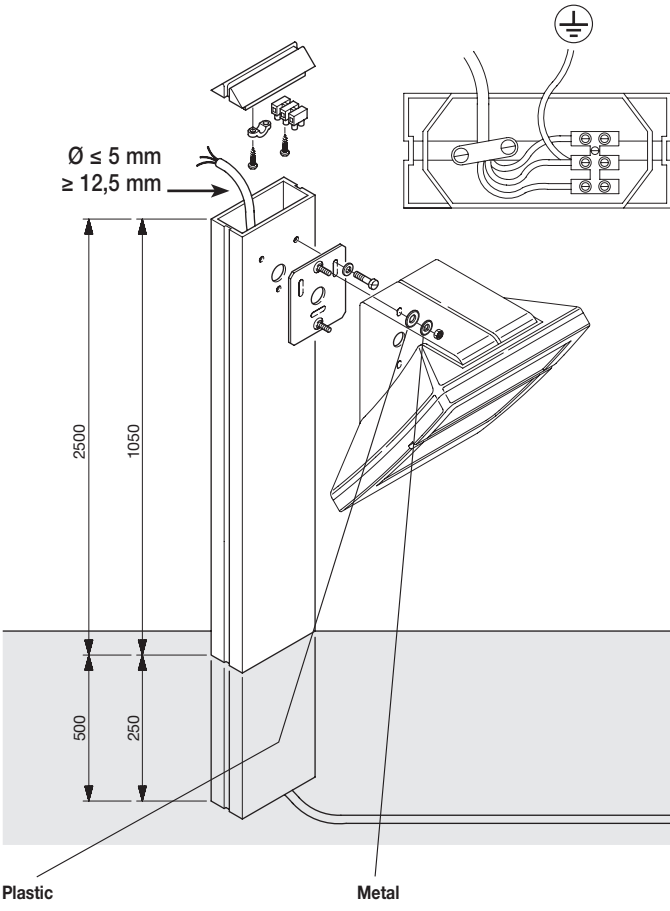
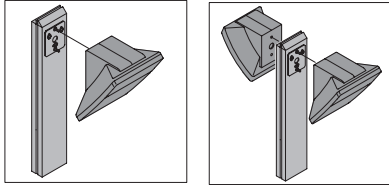



	W			
LED	Max 11W Max Ø = 70 mm Max L = 121 mm	E27	1,9	1 → 3 m

W	ILCOS	OSRAM	PHILIPS	SYLVANIA
26/32	FSM	DULUX D/E 26W DULUT T/E 32W	PLC 26W	LYNX L32

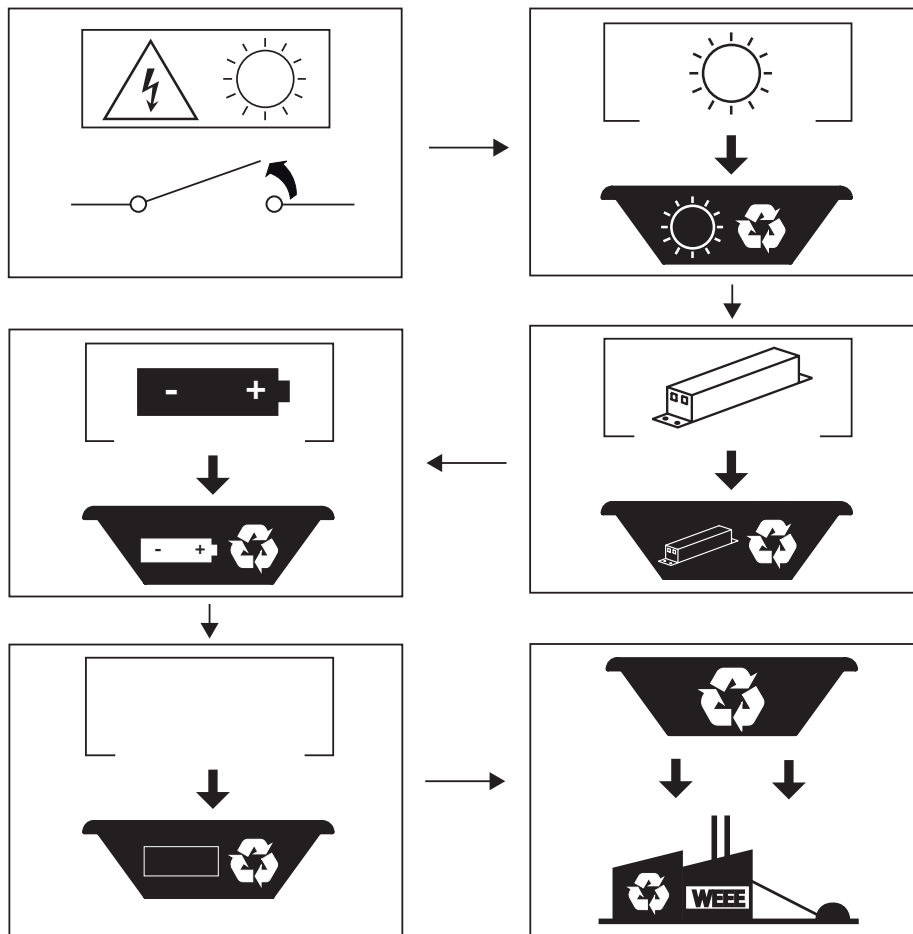
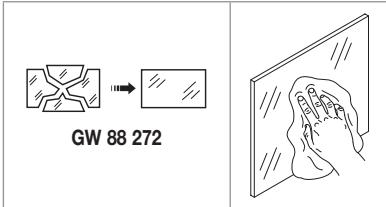

Punto di contatto indicato in adempimento ai fini delle direttive e regolamenti UE applicabili:
 Contact details according to the relevant European Directives and Regulations:

GEWISS S.p.A. Via A.Volta, 1 IT-24069 Cenate Sotto (BG) Italy tel: +39 035 946 111 E-mail: qualitymarks@gewiss.com



+39 035 946 111

8.30 - 12.30 / 14.00 - 18.00
 lunedì - venerdì - monday - friday



+39 035 946 260



sat@gewiss.com
www.gewiss.com