

NL Handleiding SOLA SDE met microwave sensor + noodunit 3u

Afmetingen:

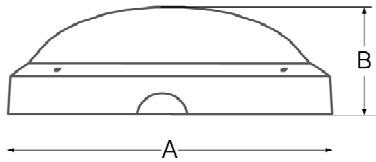

afmetingen in mm

Ref.	P	A	B
SO10STM	10W	290	103
SO18STM	18W	290	103
SO28STM	28W	350	105

meegeleverde accessoires

	schroef	3 st
	plug	3 st
	torx schroef	3 st
	torx bit	1 st
	ring	3 st
	kabel clip	1 st
	clip schroef	2 st
	afdeplug	4 st

Montage:

Muur of plafond - Ra>80Ra - Levensduur: 5 jaar - LED bron: SMD2835 - Input:220V-240V 50/60Hz

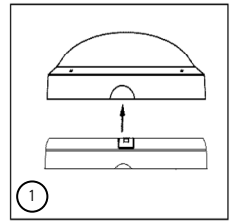

1 Verwijder de schroeven met behulp van de meegeleverde torx bit en verwijder het deksel.

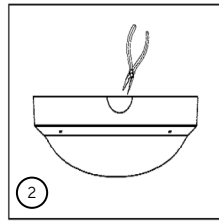

2 Verwijder indien nodig uitbreekpoorten voor de bedrading.

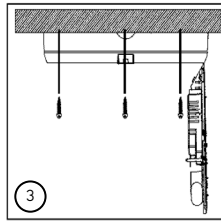

3 Druk de veiligheidsclip van de led pcb samen om te openen. Monteer de basis van het toestel.

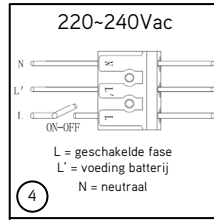

4 Voeding aansluiten. L' = moet altijd voeding krijgen, anders worden de batterijen niet opgeladen! L = na schakelaar Sluit de batterijen aan!

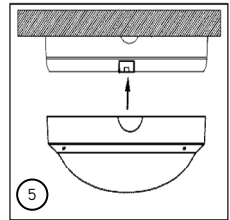

5 Lijn het deksel uit met de beschikbare kabeluitgang.

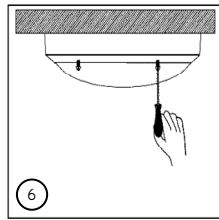

6 Plaats het deksel in positie en draai de schroeven vast.

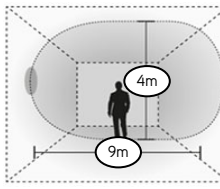
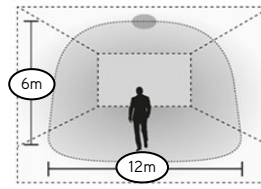

Specificaties noodunit
Batterij type: LiFePO4 6.4V - 1500mAh
Lumenoutput bij nood: 200lm-400lm
Batterijduur: 3uur
Batterij laadtijd: >12 uur
Batterij laden en volledig opgeladen: LED indicator is altijd aan
Batterij ontlading: LED indicator is uit
Levensduur batterij 4 jaar
Max. batterij werkingstemp.: 60°C
Min. batterij werkingstemp.: 0°C
Ontladingfrequentie: één keer per jaar
Garantie op batterijen: 3 jaar

Detectie zone	Tijd actief	Daglicht sensor	Stand-by periode	Stand-by dimniveau
I ● ● ● 100%	I ● ● ● 5s	I ● ● ● Disablic	I ● ● ● 0s	I ● ● ● 10%
II ● ● ● 75%	II ● ● ● 30s	II ● ● ● 50Lux	II ● ● ● 1min	II ● ● ● 20%
III ● ● ● 50%	III ● ● ● 1min	III ● ● ● 10Lux	III ● ● ● 5min	III ● ● ● 30%
IV ● ● ● sensor on	IV ● ● ● 5min	IV ● ● ● 2 Lux	IV ● ● ● 10min	IV ● ● ● 50%
	V ● ● ● 10min		V ● ● ● 30min	
	VI ● ● ● 20min		VI ● ● ● 1h	
	VII ● ● ● 30min		VII ● ● ● +∞	
	VIII ● ● ● 30min		VIII ● ● ● +∞	



FR Manuel d'installation SOLA SDE avec capteur à micro-ondes + unité de secours 3h

Dimensions

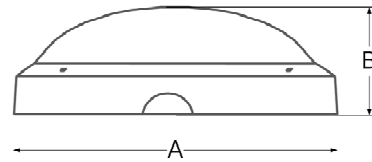

Dimensions en mm

Ref.	P	A	B
SO10STM	10W	290	103
SO18STM	18W	290	103
SO28STM	28W	350	105

accessoires inclus

	vis	3 st
	cheville	3 st
	vis torx	3 st
	bit torx	1 st
	rondelle	3 st
	clip câble	1 st
	clip vis	2 st
	bouchon	4 st

Montage:

Mur ou plafond- Ra>80 - Durée de vie: 5 ans - Source LED: SMD2835 - Input:220V-240V 50/60Hz

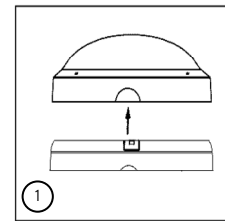

1 Retirez les vis à l'aide du bit Torx fourni et retirez le couvercle.

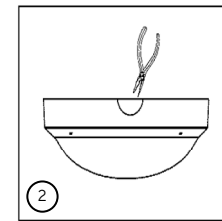

2 Si nécessaire, retirez les ports de dérivation pour le câblage.

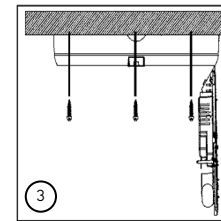

3 Appuyez sur le clip de sécurité de la pcb led pour l'ouvrir. Montez la base de l'appareil.

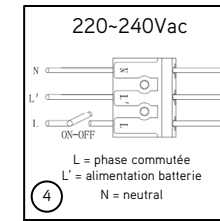

4 Branchez l'alimentation L' = doit toujours être connecté, sinon les batteries ne seront pas chargées! L = après interrupteur Branchez les batteries!

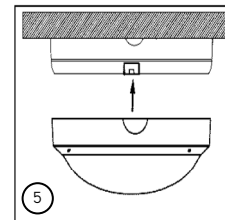

5 Alignez le couvercle avec la sortie de câble disponible.

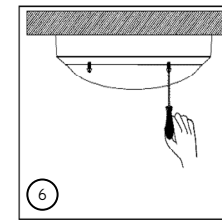

6 Mettez le couvercle en place et serrez les vis.

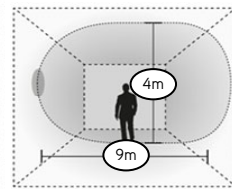
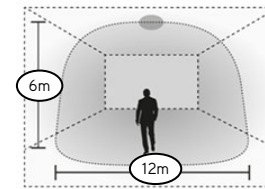

Spécifications unité de secours
Type de batterie: LiFePO4 6.4V - 1500mAh
Flux lumineux en cas d'urgence: 200lm-400lm
Durée chargement batterie: >12 h
Chargement & chargée: indicateur LED est allumé
Décharge de la batterie: indicateur LED est éteint
Durée de vie batterie 4 ans
Température ambian max. batterie: 60°C
Température ambian min. batterie: 0°C
Fréquence de décharge: une fois par an
Garantie sur les batteries: 3 ans

Zone detection	Temps actif	Capt lum du jour	Période stand-by	Niveau dimming stand-by
I ● ● ● 100%	I ● ● ● 5s	I ● ● ● Disablic	I ● ● ● 0s	I ● ● ● 10%
II ● ● ● 75%	II ● ● ● 30s	II ● ● ● 50Lux	II ● ● ● 1min	II ● ● ● 20%
III ● ● ● 50%	III ● ● ● 1min	III ● ● ● 10Lux	III ● ● ● 5min	III ● ● ● 30%
IV ● ● ● sensor on	IV ● ● ● 5min	IV ● ● ● 2 Lux	IV ● ● ● 10min	IV ● ● ● 50%
	V ● ● ● 10min		V ● ● ● 30min	
	VI ● ● ● 20min		VI ● ● ● 1h	
	VII ● ● ● 30min		VII ● ● ● +∞	
	VIII ● ● ● 30min		VIII ● ● ● +∞	



L'installation et la maintenance doivent toujours être effectuées par du personnel qualifié.
La source lumineuse de ce luminaire n'est pas remplaçable, le luminaire doit être remplacé à la fin de sa vie.
Ne touchez pas les puces led pendant l'entretien ou le nettoyage. N'utilisez pas de solutions chimiques pour le nettoyage de cet appareil.
Les appareils endommagés dans leur emballage d'origine sont échangés sous garantie.
La mise à la terre doit toujours être correctement connectée pour éviter tout problème de sécurité.
Toujours vérifier si la tension de connexion correcte est présente.



Lampes usagées
Toujours ramener les appareils à LED usés ou défectueux à un point de collecte approprié, conformément aux réglementations en vigueur en matière de protection de l'environnement. Les lampes usagées peuvent être déposées dans un point de recyclage où elles sont acceptées gratuitement. Une utilisation appropriée des équipements permet de préserver des ressources environnementales précieuses et d'éviter des conséquences négatives pour la santé et l'environnement.

ENG Manual SOLA SDE with microwave sensor + emergency unit 3h

Dimensions:

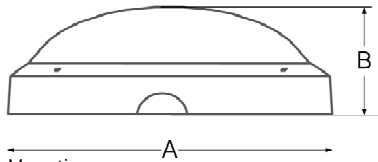

dimensions in mm

Ref.	P	A	B
SO10STM	10W	290	103
SO18STM	18W	290	103
SO28STM	28W	350	105

included accessories

	screw	3 st
	plug	3 st
	torx screw	3 st
	torx bit	1 st
	ring	3 st
	cable clip	1 st
	clip screw	2 st
	silicon plug	4 st

Mounting:

Wall or ceiling - Ra>80 - Lifetime: 5 years - LED source: SMD2835 - Input:220V-240V 50/60Hz

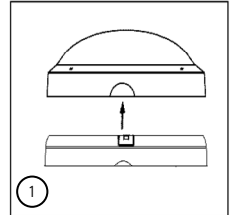

Remove the screws using the supplied torx bit and remove the cover.

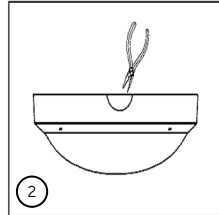

If necessary, remove break-out ports for the wiring.

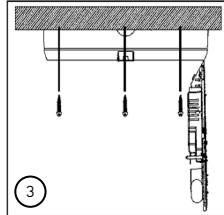

Press the security clip of the led pcb together to open. Mount the base of the device.

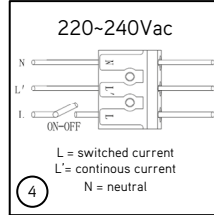

Connect power supply. L = switched current L' = continuous current N = neutral L = after switch Connect the batteries

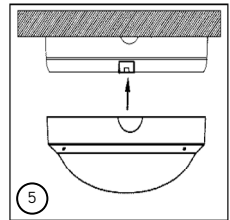

Align the cover with the available cable outlet.

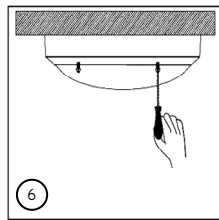

Place the cover in position and tighten the screws.

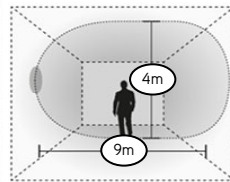
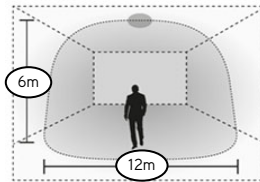

Specifications if with emergency unit

Battery: LiFePO4 6,4V - 1500mAh
Lumenoutput emergency light: 200lm-400lm
Batteries duration: 3uur
Battery charging period: >12 h
Battery charging & fully charged status: LED indicator is always on
Battery discharge: LED indicator is off
Battery life 4 years
Max. battery operating temperature: 60°C
Min. battery operating temperature: 0°C
Discharge frequency: Once a year
Warranty batteries: 3 years

Detection zone	Time actif	Daylight sensor	Stand-by periode	Stand-by dim level
I 1 2 3	I 1 2 3	I 1 2	I 1 2	I 1 2
100%	5s	Okobloke	0s	10%
75%	30s	50LUX	10s	20%
50%	1min	10LUX	1min	30%
Sensor (PH)	5min	2 Lux	5min	50%
	10min		10min	
	20min		30min	
	30min		1h	
			+∞	



Installation and maintenance should always be done by qualified personnel.
The light source of this fixture is not replaceable, the luminaire must be replaced at the end of its life.
Damaged devices in original packaging are exchanged under guarantee.
Do not touch the LEDs on the circuit board during maintenance or cleaning. Do not use chemical solutions for the cleaning of this appliance.
The grounding must be correctly connected at all times to prevent safety problems.
Always check whether the correct connection voltage is present.



Used lamps
Always return old or defective LED fixtures to an appropriate collection point in accordance with the applicable regulations regarding environmental protection. Used lamps can be deposited at a recycling point where they are accepted for free. Proper use of equipment makes it possible to preserve valuable environmental resources and prevent negative consequences for health and the environment.