

**MODULO CON BOBINA PER AUDIOLESI
HEARING IMPAIRED PEOPLE MODULE
MODULE AVEC BOBINE POUR MALENTENDANTS
MÓDULO CON BOBINA PARA PERSONAS CON PROBLEMA DE
OÍDO
MODUL MIT SPULE FÜR HÖRBEHINDERTE**

Sch./Ref. 1148/48

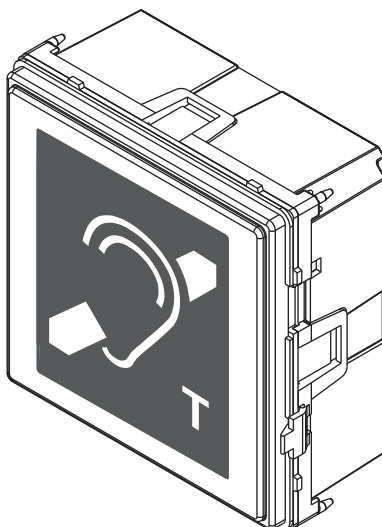

ITALIANO

Il modulo con bobina ILA (Induction Loop Antenna) Sch.1148/48 è un modulo che permette agli utenti con problemi di udito di ascoltare la conversazione audio sul posto esterno tramite il proprio apparecchio acustico. L'apparecchio acustico deve essere dotato di interfaccia magnetica di tipo "T".

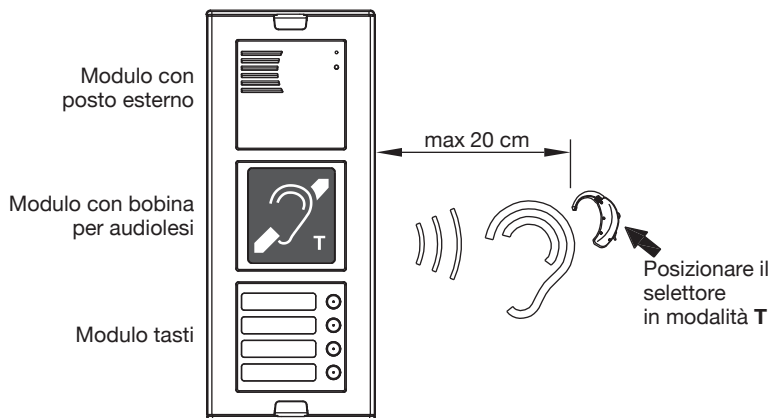

INSTALLAZIONE

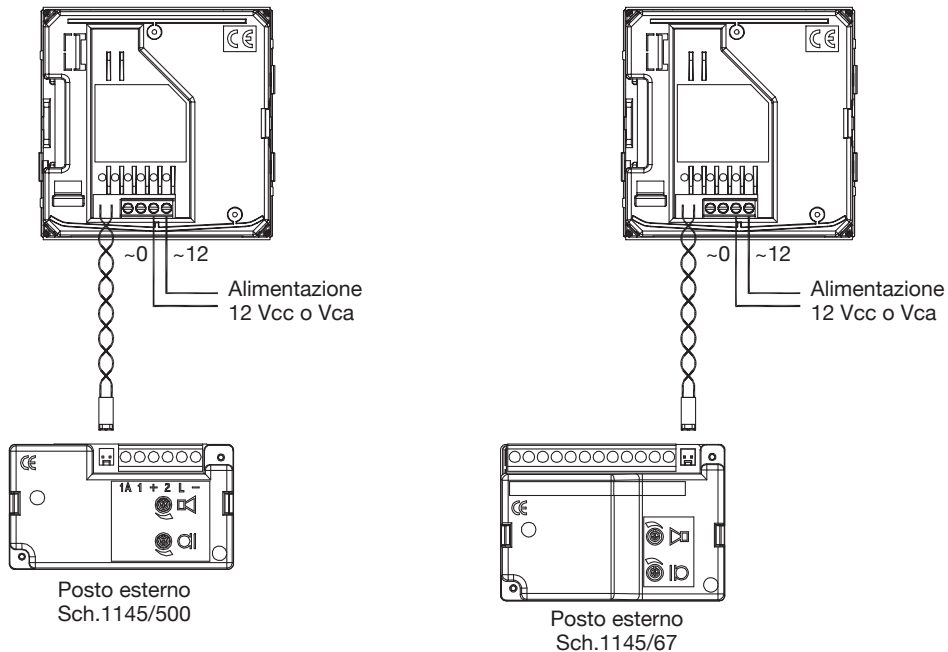

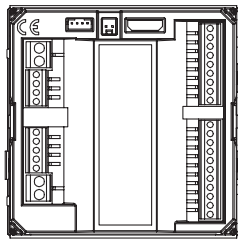
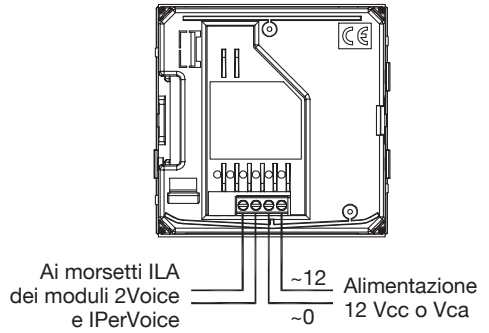
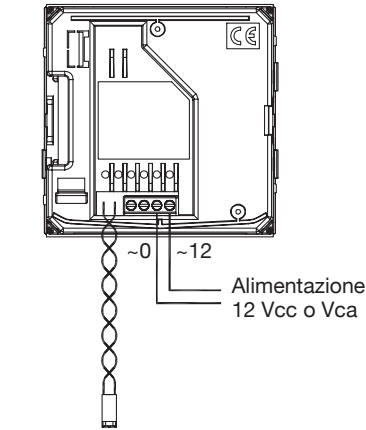

Posto esterno
Sch.1072/9

DESCRIZIONE DEI MORSETTI

- ILA** coppia di morsetti da collegare ai morsetti ILA delle postazioni di chiamata 2Voice e IPerVoice
- ~12** alimentazione 12 Vca o 12 Vcc
- ~0** massa alimentazione

 *Prevedere un dispositivo di alimentazione dedicato per il modulo Sch.1148/48.*

CARATTERISTICHE TECNICHE

Tensione di alimentazione	12 Vca o Vcc
Assorbimento max	100 mA @ 12 Vcc
	200 mA @ 12 Vca
Temperatura di funzionamento	-5 ÷ +45 °C

ENGLISH

ILA (Induction Loop Antenna) T-coil module Ref. 1148/48 allows hard of hearing to hear door unit audio conversations with the hearing aid. The hearing aid must be equipped with a T-magnetic interface.

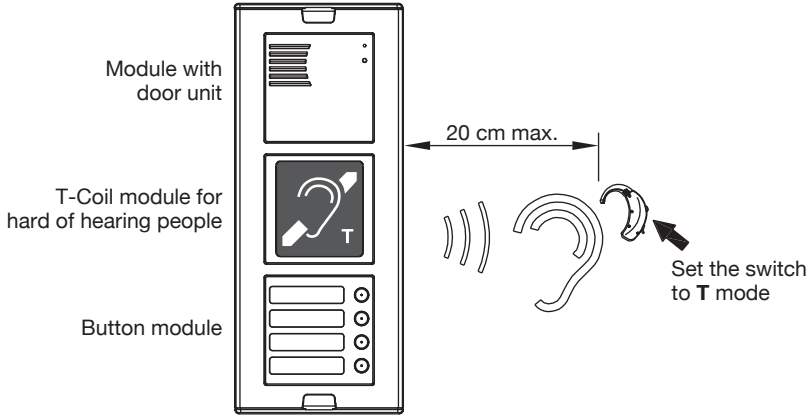

INSTALLATION

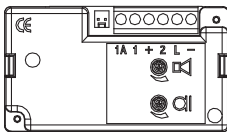
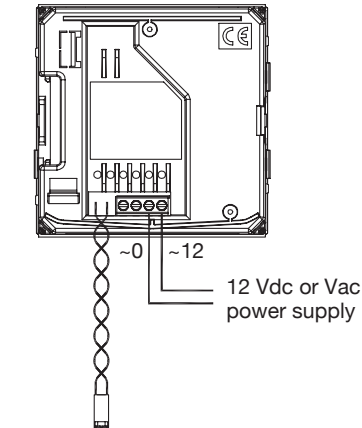

Ref. 1145/500
door unit

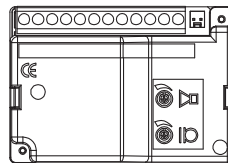
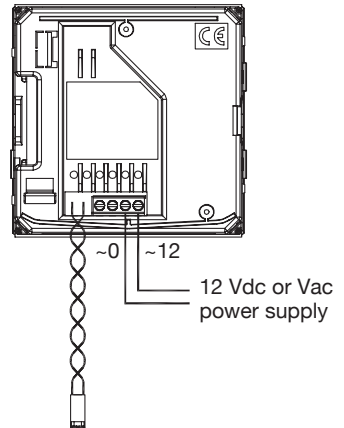

Ref. 1145/67
door unit

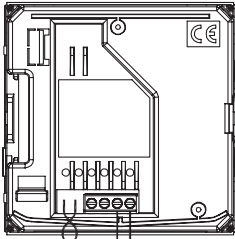

~0 ~12
12 Vdc or Vac power supply

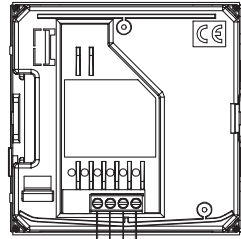

To ILA terminal pins of 2Voice or IPerVoice modules
~12 12 Vcc or Vac power supply
~0

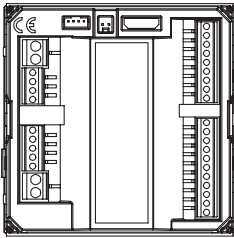

Ref. 1072/9 door unit

TERMINAL PINS DESCRIPTION

ILA ILA two terminal pins to be connected to ILA terminal in 2Voice or IPerVoice systems

~12 12 Vac or 12 Vdc power supply

~0 power supply ground

 A power supply device dedicated to Ref. 1148/48 module is needed.

TECHNICAL CHARACTERISTICS

Power supply voltage	12 Vac or Vdc
Max. current consumption	100 mA @ 12 Vdc
	200 mA @ 12 Vac
Operating temperature range	-5 ÷ +45 °C

FRANÇAIS

Le module avec bobine ILA (Induction Loop Antenna) Réf.1148/48 est un module qui permet aux malentendants d'écouter une conversation sonore sur le poste externe avec leur appareil auditif. Cet appareil auditif doit être muni d'une interface magnétique de type « T ».

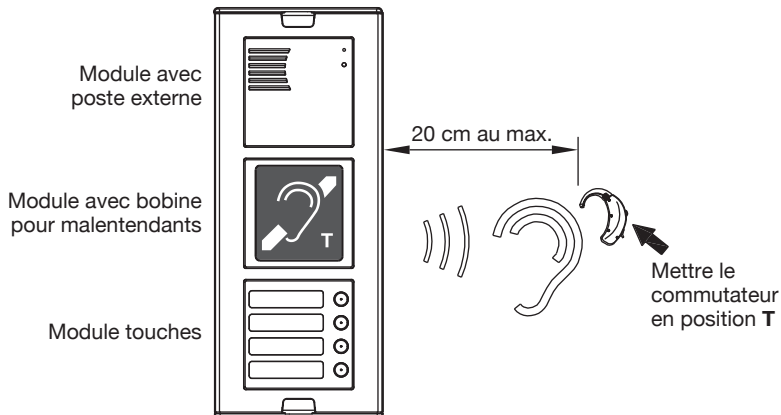

INSTALLATION

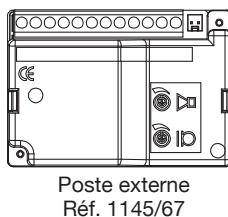
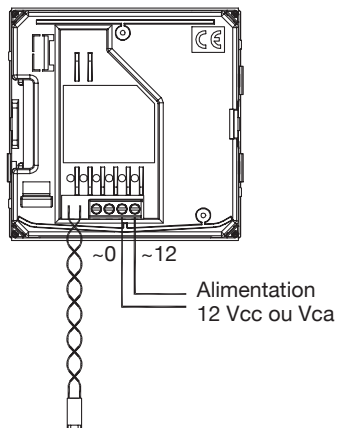
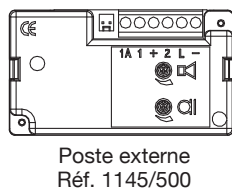
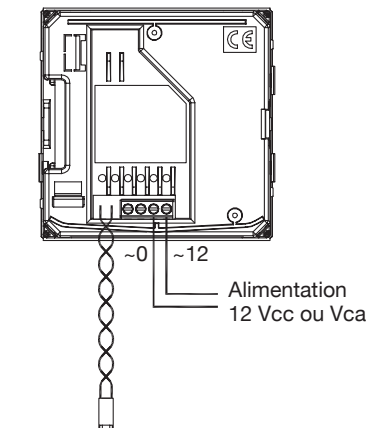

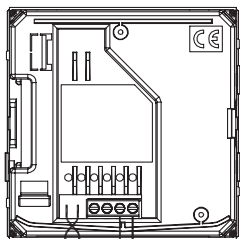

~0
~12
Alimentation
12 Vcc ou Vca

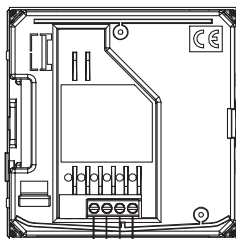

Aux bornes ILA
des modules
2Voice ou IPerVoice
~12 Alimentation
12 Vcc ou Vca
~0

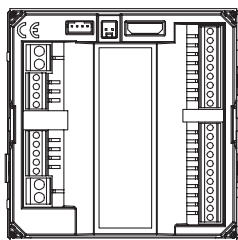

Poste externe
Réf. 1072/9

DESCRIPTION DES BORNES

ILA ILA couple de bornes à raccorder aux bornes ILA des postes d'appel 2Voice ou IPerVoice

~12 alimentation 12 Vca ou 12 Vcc

~0 masse alimentation

 Prévoir un dispositif d'alimentation dédié pour le module Réf. 1148/48.

CARACTÉRISTIQUES TECHNIQUES

Tension d'alimentation	12 Vca o Vcc
Consommation de courant max.....	100 mA @ 12 Vcc 200 mA @ 12 Vca
Température de fonctionnement.....	-5 ÷ +45 °C

ESPAÑOL

El módulo con bobina ILA (Induction Loop Antenna) Ref.1148/48 es un módulo que permite a los usuarios con problemas de oído de escuchar la conversación audio en el microaltavoz por medio de su propio aparato acústico. El aparato acústico tiene que tener un interfaz magnetico de tipo "T".

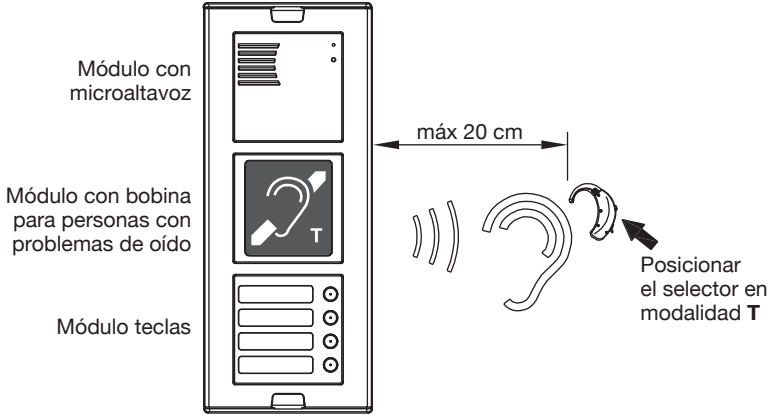

INSTALACIÓN

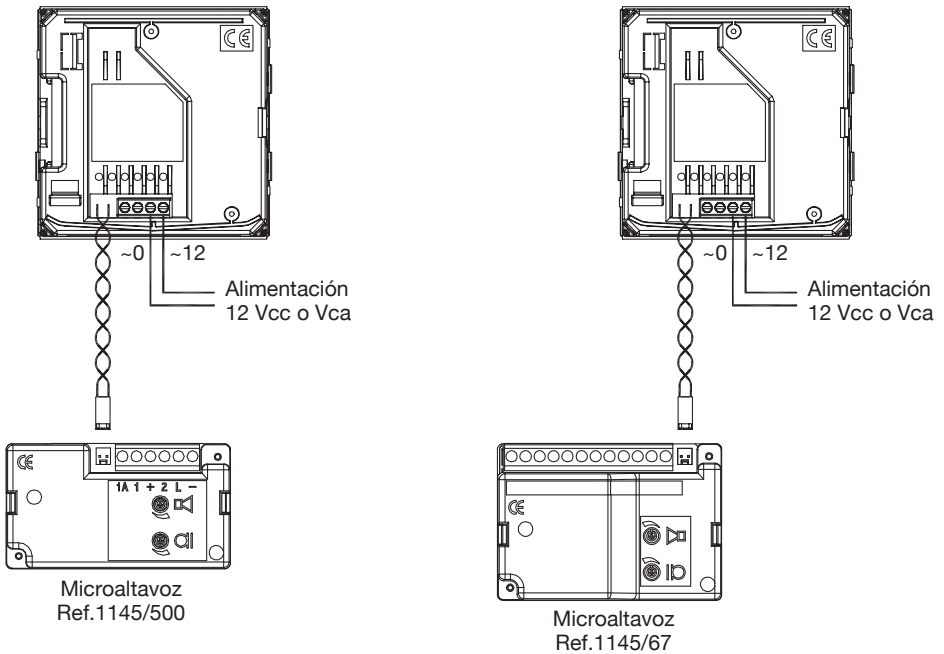

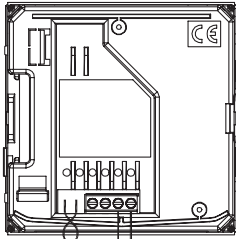

Alimentación
12 Vcc o Vca

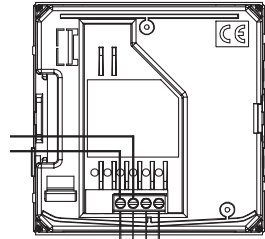

Hacia los bornes ILA
de los módulos
2Voice o IPerVoice

Alimentación
12 Vcc o Vca

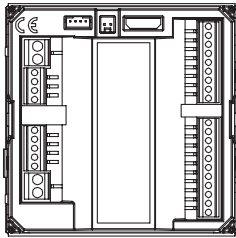

Microaltavoz
Ref.1072/9

DESCRIPCIÓN DE LOS BORNES

- ILA** ILA par de bornes que se conectan a los bornes ILA de las posiciones de llamadas 2Voice o IPerVoice
- ~12** alimentación 12 Vca o 12 Vcc
- ~0** masa alimentación

 Prever un dispositivo de alimentación dedicado para el módulo Ref.1148/48.

CARACTERÍSTICAS TÉCNICAS

Tensión de alimentación	12 Vca o Vcc
Absorción máx	100 mA @ 12 Vcc 200 mA @ 12 Vca
Temperatura de funcionamiento	-5 ÷ +45 °C

DEUTSCH

Das Modul mit ILA (Induction Loop Antenna) T-Spule BN 1148/48 ermöglicht den Teilnehmern mit Hörproblemen das Gespräch auf der Außenstelle über das eigene Hörgerät zu hören. Das Hörgerät muss über eine magnetische T-Schnittstelle verfügen.

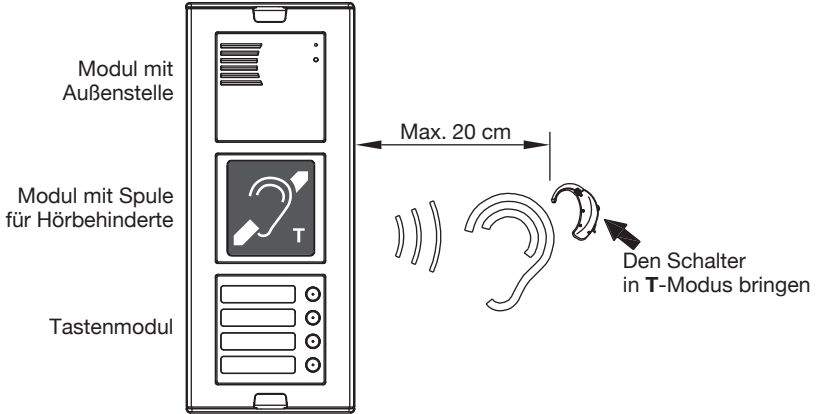

INSTALLATION

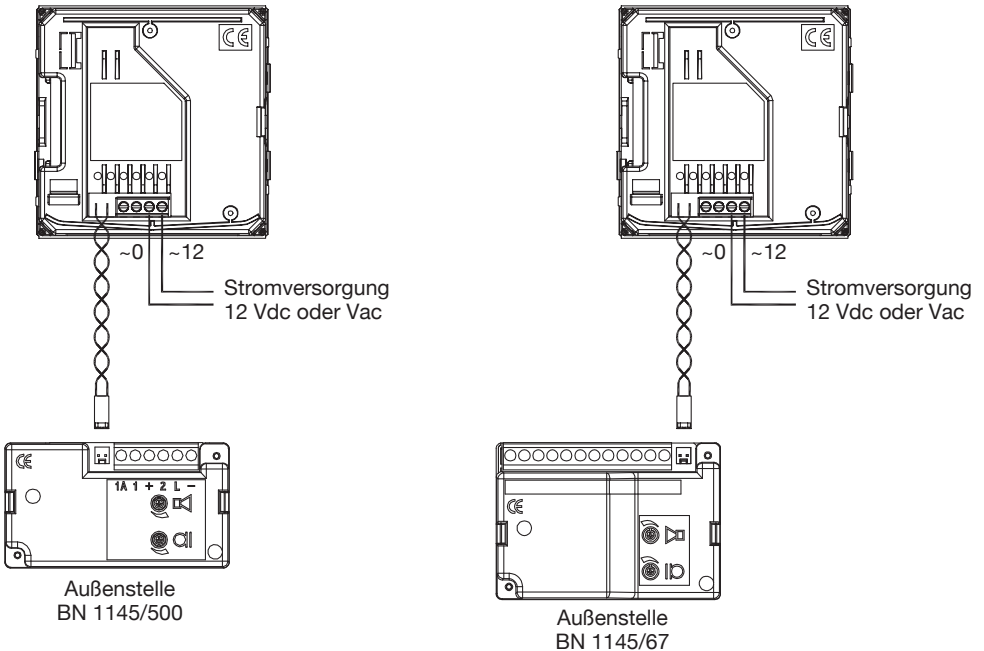

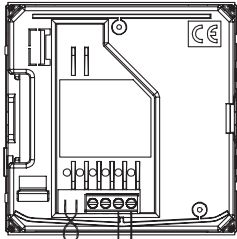

~0
~12
Stromversorgung
12 Vdc oder Vac

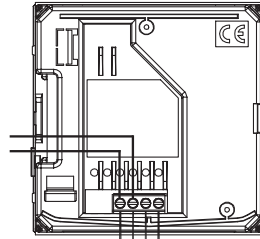

Zu den ILA-Klemmen
der Module 2Voice
oder IPerVoice
~12 Stromversorgung
12 Vdc oder Vac
~0

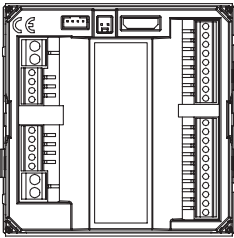

Außenstelle
BN 1072/9

BESCHREIBUNG DER KLEMMEN

ILA ILA-Klemmenpaar zum Anschluss an ILA-Klemmen der Module 2Voice oder IPerVoice

~12 Stromversorgung 12 Vdc oder 12 Vac

~0 Versorgungsmasse

 Eine Vorrichtung zur Stromversorgung speziell für das Modul BN 1148/48 vorsehen.

TECHNISCHE EIGENSCHAFTEN

Versorgungsspannung	12 Vdc oder Vac
Max. Stromaufnahme	100 mA @ 12 Vdc 200 mA @ 12 Vac
Betriebstemperatur	-5 ÷ +45 °C

DS 1148-009

URMET S.p.A.
10154 TORINO (ITALY)
VIA BOLOGNA 188/C
Telef. +39 011.24.00.000 (RIC. AUT.)
Fax +39 011.24.00.300 - 323

urmet

LBT 8769

Area tecnica
servizio clienti +39 011.23.39.810
<http://www.urmet.com>
e-mail: info@urmet.com