

NH fuse-links gTr 400VAC

top indicator/live gripping-lugs size 2, 3, 4a

LOW VOLTAGE IEC FUSES

IEC NH FUSE-LINKS



The NH system is classified among plug-in fuse systems and is composed of:

- fuse-base, (possibly including terminal covers and phase barriers)
- fuse-link with blade contact
- fuse-link replacement device (LV HRC fuse puller)

Since the design of this system cannot guarantee non-interchangeability of rated current, it must be handled by a qualified professional.

NH-fuse links „gTr“ are used for the protection of transformers. The time/current characteristic is especially adapted to that of the protected transformer and implies optimal selectivity to NH-fuse links characteristic gG. The fuses can be loaded with 1,3 times nominal current for up to 10 hours. The fuse link operates at 1,5 times nominal transformer current within 2 hours.

TECHNICAL DATA OVERVIEW

| | |
|---------------------------------|-----------------------|
| Voltage AC | 400 VAC |
| Nominal capacity of transformer | 50 ... 1000 kVA |
| Ampere Range (A) | 72 ... 1443 A |
| Size per Standard | Sizes 2, 3, 4a |
| Speed/Characteristic | gTr |
| I.R. AC (IEC) | 100 kA |
| Body Material | ceramic |
| Contact Materials | copper, silver-plated |

FEATURES & BENEFITS

- Maximum transformer capacity (up to 1,3 x In)
- Reduction of unnecessary interruption of operation
- Precise cut off of overload
- Characteristic adapted to the transformer
- Resistant to ageing
- Selectivity to fuse links gG
- High current limiting
- High breaking capacity
- Easy selection between transformer and fuse link

APPLICATIONS

- Protection of transformers

STANDARDS

- VDE 0636 Part 201
- IEC 60269-1 and -2



NH fuse-links gTr 400VAC

top indicator/live gripping-lugs size 2, 3, 4a

PRODUCT RANGE



NH22GTR250KVA-8

Size 2 gTr 400VAC top indicator

| Catalog number | Item number | Rated current I_n | Power dissipation at I_n | Transformer nominal capacity | Width | Weight | Package |
|-----------------|-------------|---------------------|----------------------------|------------------------------|-------|--------|---------|
| NH2GTR50KVA-8 | Z1028697 | 72 A | 5.5 W | 50 kVA | 40 mm | 0.5 kg | 3/30 |
| NH2GTR75KVA-8 | A1028698 | 108 A | 7.3 W | 75 kVA | 40 mm | 0.5 kg | 3/30 |
| NH2GTR100KVA-8 | B1028699 | 144 A | 9 W | 100 kVA | 40 mm | 0.5 kg | 3/30 |
| NH2GTR125KVA-8 | D1028701 | 180 A | 11.2 W | 125 kVA | 40 mm | 0.5 kg | 3/30 |
| NH2GTR160KVA-8 | E1028702 | 231 A | 14 W | 160 kVA | 40 mm | 0.5 kg | 3/30 |
| NH22GTR200KVA-8 | F1028703 | 289 A | 16 W | 200 kVA | 50 mm | 0.5 kg | 3/24 |
| NH22GTR250KVA-8 | G1028704 | 361 A | 21 W | 250 kVA | 50 mm | 0.5 kg | 3/24 |



NH32GTR630KVA-8

Size 3 gTr 400VAC top indicator

| Catalog number | Item number | Rated current I_n | Power dissipation at I_n | Transformer nominal capacity | Width | Weight | Package |
|-----------------|-------------|---------------------|----------------------------|------------------------------|-------|--------|---------|
| NH3GTR75KVA-8 | L1028708 | 108 A | 7.3 W | 75 kVA | 50 mm | 1 kg | 1 |
| NH3GTR100KVA-8 | M1028709 | 144 A | 9 W | 100 kVA | 50 mm | 1 kg | 1 |
| NH3GTR125KVA-8 | N1028710 | 180 A | 11.2 W | 125 kVA | 50 mm | 1 kg | 1 |
| NH3GTR160KVA-8 | P1028711 | 231 A | 14 W | 160 kVA | 50 mm | 1 kg | 1 |
| NH3GTR200KVA-8 | Q1028712 | 289 A | 16 W | 200 kVA | 50 mm | 1 kg | 1 |
| NH3GTR250KVA-8 | R1028713 | 361 A | 21 W | 250 kVA | 50 mm | 1 kg | 1 |
| NH32GTR315KVA-8 | S1028714 | 455 A | 25 W | 315 kVA | 71 mm | 1 kg | 1 |
| NH32GTR400KVA-8 | T1028715 | 577 A | 31 W | 400 kVA | 71 mm | 1 kg | 1 |
| NH32GTR500KVA-8 | V1028716 | 722 A | 53 W | 500 kVA | 71 mm | 1 kg | 1 |
| NH32GTR630KVA-8 | W1028717 | 909 A | 62 W | 630 kVA | 71 mm | 1 kg | 1 |

Size 4a gTr 400VAC top indicator

| Catalog number | Item number | Rated current I_n | Power dissipation at I_n | Transformer nominal capacity | Width | Weight | Package |
|-----------------|-------------|---------------------|----------------------------|------------------------------|-------|--------|---------|
| NH4AGTR100KVA-8 | E1028725 | 144 A | 12 W | 100 kVA | 73 mm | 2.2 kg | 1 |
| NH4AGTR125KVA-8 | F1028726 | 180 A | 15 W | 125 kVA | 73 mm | 2.2 kg | 1 |
| NH4AGTR160KVA-8 | G1028727 | 231 A | 18 W | 160 kVA | 73 mm | 2.2 kg | 1 |
| NH4AGTR200KVA-8 | H1028728 | 289 A | 23 W | 200 kVA | 73 mm | 2.2 kg | 1 |
| NH4AGTR250KVA-8 | J1028729 | 361 A | 28 W | 250 kVA | 73 mm | 2.2 kg | 1 |
| NH4AGTR315KVA-8 | K1028730 | 455 A | 32 W | 315 kVA | 73 mm | 2.2 kg | 1 |
| NH4AGTR400KVA-8 | L1028731 | 577 A | 39 W | 400 kVA | 73 mm | 2.2 kg | 1 |
| NH42GTR500KVA-8 | V1030487 | 722 A | 49 W | 500 kVA | 98 mm | 2.2 kg | 1 |
| NH42GTR630KVA-8 | W1030488 | 909 A | 66 W | 630 kVA | 98 mm | 2.2 kg | 1 |
| NH42GTR800KVA-8 | Y1030490 | 1155 A | 81 W | 800 kVA | 98 mm | 2.2 kg | 1 |
| NH42GR1000KVA-8 | B1029067 | 1443 A | 108 W | 1000 kVA | 98 mm | 2.2 kg | 1 |

MERSEN reserves the right to change, update or correct, without notice, any information contained in this datasheet.

NH fuse-links gTr 400VAC

top indicator/live gripping-lugs size 2, 3, 4a

TIME CURRENT CHARACTERISTIC CURVES

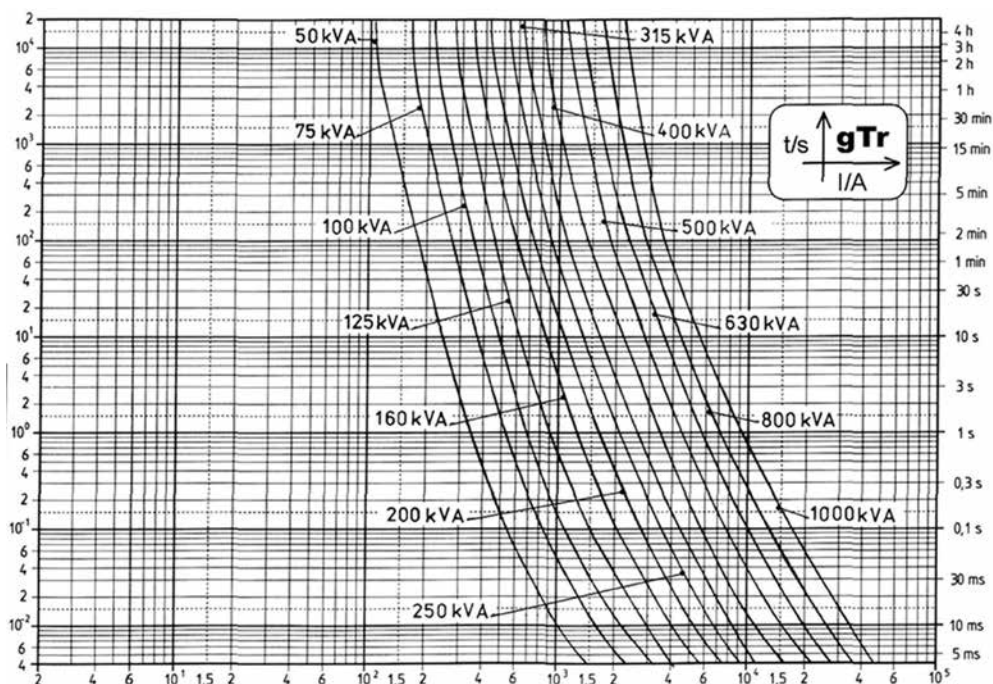

MERSEN reserves the right to change, update or correct, without notice, any information contained in this datasheet.

NH fuse-links gTr 400VAC

top indicator/live gripping-lugs size 2, 3, 4a

CUT-OFF CURRENT CHARACTERISTIC

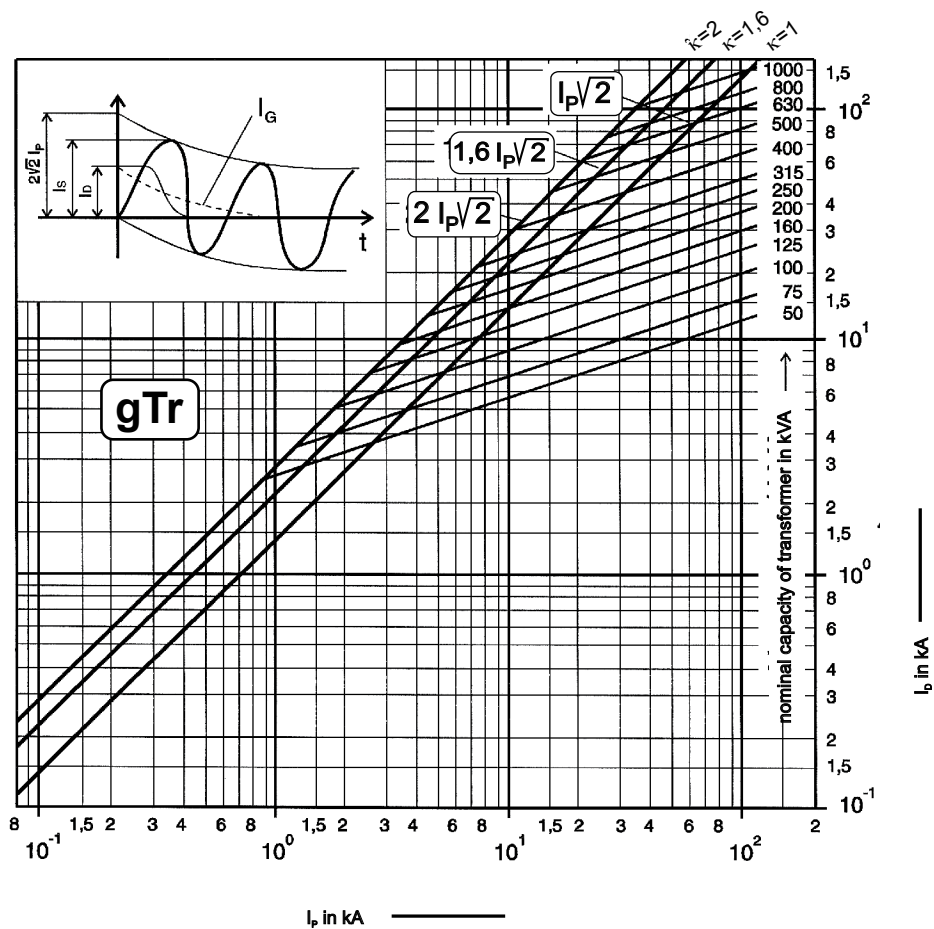

CORRECTION FACTOR

Correction factor of aperiodic component

a ... short_circuit current without direct current component ($k = 1$)

b ... short circuit current with direct current component ($k = 2$)

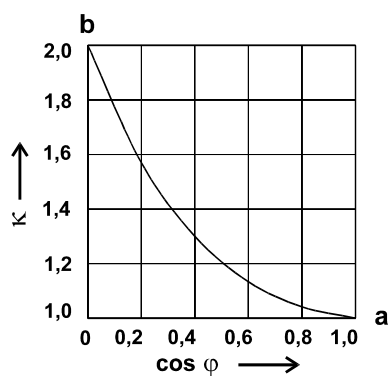

NH fuse-links gTr 400VAC

top indicator/live gripping-lugs size 2, 3, 4a

DIMENSIONS

IEC LV NH_fuse link gTr size 2, 3, 4a (M02037_gTr)

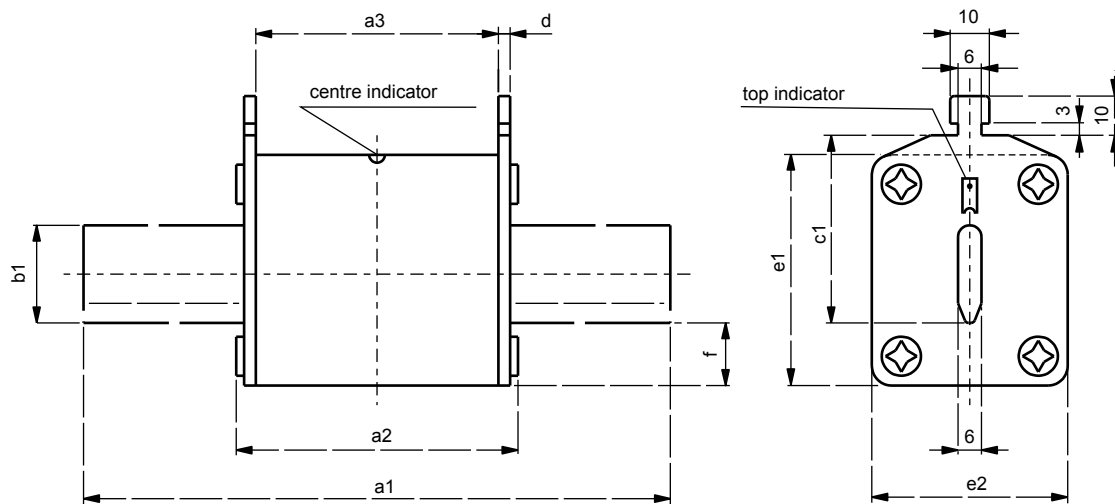

| size | a1 | a2 | a3 | b1 | c1 | d | e1 | e2 | f | design | |
|------|-----|----|----|----|----|-----|-----|----|----|--------------------|-------------------------|
| 2 | 150 | 72 | 62 | 20 | 48 | 2.5 | 48 | 40 | 12 | live tags compact | |
| | | | | 25 | | | 59 | 50 | | live tags standard | |
| | | 74 | 64 | 20 | | 2 | 53 | 42 | | 14 | insulated tags compact |
| | | | | 25 | | | 60 | 53 | | | insulated tags standard |
| 3 | 150 | 73 | 62 | 25 | 60 | 2.8 | 59 | 50 | 13 | live tags compact | |
| | | | | 32 | | | 71 | 71 | | 17 | live tags standard |
| | | 74 | 64 | 25 | | 2 | 60 | 53 | | 14 | insulated tags compact |
| | | 73 | 62 | 32 | | | 75 | 73 | | 17 | insulated tags standard |
| 4a | 200 | 96 | 82 | 50 | 85 | 4.0 | 109 | 98 | 27 | live tags | |

Dimensions in mm

MERSEN reserves the right to change, update or correct, without notice, any information contained in this datasheet.