

P31 Flat T H100 PG

Reference(s) : 347 575 to 581

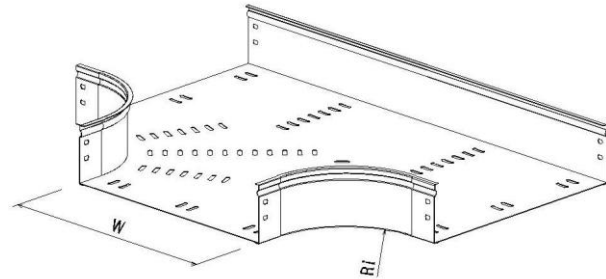
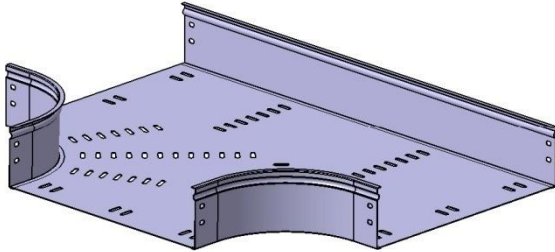

Ref.	Description	Raw Material (R.M.)	R.M. Standard	W (mm)	Ri (mm)	Thickness (mm)	Weight (kg)
347 575	Flat T P31 H100 W100	DX51D Z275 (RE MIN 220 MPA)	EN10346	100	100	1	1.2
347 576	Flat T P31 H100 W150	DX51D Z275 (RE MIN 220 MPA)	EN10346	150	100	1	1.5
347 577	Flat T P31 H100 W200	DX51D Z275 (RE MIN 220 MPA)	EN10346	200	100	1	1.8
347 578	Flat T P31 H100 W300	DX51D Z275 (RE MIN 220 MPA)	EN10346	300	100	1	2.6
347 579	Flat T P31 H100 W400	DX51D Z275 (RE MIN 220 MPA)	EN10346	400	150	1	5.0
347 580	Flat T P31 H100 W500	DX51D Z275 (RE MIN 220 MPA)	EN10346	500	150	1	5.7
347 581	Flat T P31 H100 W600	DX51D Z275 (RE MIN 220 MPA)	EN10346	600	150	1	6.3